

EXOSKELETON
www.hyetone.com

EXO

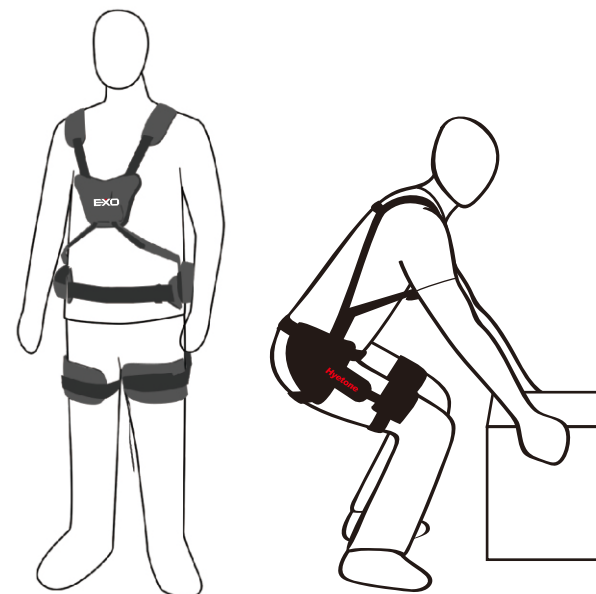

PHES | 金属腰
PWIND0401

Quick Guide
产品使用说明



Hyetone™ 海同工业 www.hyetone.com

HOTLINE
400 018 2086

广州海同工业技术有限公司

地址：广东省广州市白云区西槎路聚龙工业区799号6栋一楼
电话：020-36464335
传真：020-36464300

武汉海同机器人控制系统有限公司

地址：湖北省武汉市洪山区邮科院路88号武汉国际创客中心
一号楼5层2区
电话：027-85630916

Guangzhou Hyetone Industrial Technologies Co., Ltd.
Block 6, 799 Xicha Rd., Baiyun District, Guangzhou,
Guangdong Province, P.R.China. 510407
Tel: +86-20-36464335
Fax: +86-20-36464300

Wuhan Hyetone Robotics and Control Systems Co., Ltd.
Zone 2, 5th Floor, Block 1, Wuhan International Creator
Center, 88 Youkeyuan Rd., Hongshan District, Wuhan,
Hubei Province, P.R.China. 430074
Tel: +86-27-85630916

Contents

目录

物品清单	-----P01
产品参数	-----P02
产品组装	-----P03
结构示意图	-----P04
穿戴定位	-----P05
穿戴设置	-----P06
使用建议	-----P08
危险警示	-----P09
联系我们	-----P10
维护保养	-----P11
保修售后	-----P12
Packing List	-----P13
Specification	-----P14
Product assembly	-----P15
Vest Hardware	-----P16
Wear positioning	-----P17
Setup	-----P18
Use Tips	-----P20
Warnings	-----P21
Contact us	-----P22
Maintenance	-----P23
Maintenance/Repair	-----P24

Maintenance/Repair

WARRANTY CARD

Name _____ Time _____
Model _____ Serial number _____

Date	Problem and Approach	Work done	Signature

One of the following conditions is not within the scope of the exemption

- ☐ Product failure caused by not complying with this quick guide
- ☐ Failure caused by self-disassembly and repair
- ☐ Failure caused by accident, misuse, misuse, intentional damage

Within one year from the purchase, under normal use, the purchaser can contact the manufacturer to provide free service with the sales invoice, "warranty card" and other purchase vouchers. For products that are out of warranty or are not subject to free repair, the company's technical service department will also provide paid services.

The manufacturing unit has the right to modify, and All contents in this manual have been carefully checked. If there are any printing errors or misunderstandings, the company reserves the right of final interpretation.

物品清单

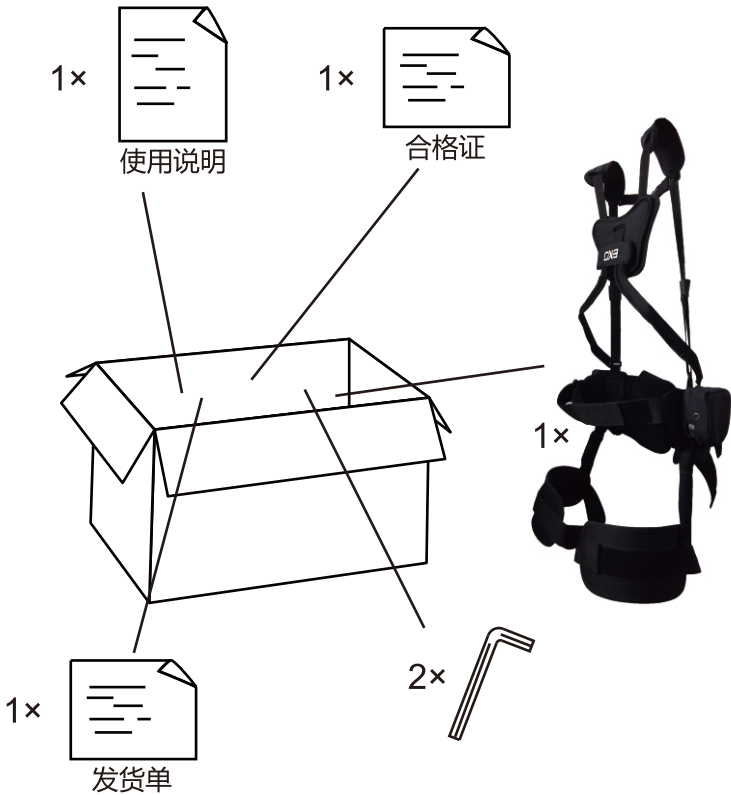

产品参数

规格型号	PWIND0401
自重	≤3.5kg
适用身高	1.6~1.85m
适用体重	40~85kg
助力效果	≥60%

PW-IND-04-01-M-BK

产品 种类 规格 版本号 尺寸 颜色

注意

- 1.表中参数仅供参考，具体以实物铭牌为准
- 2.保留更改产品设计与规格的权利

Maintenance

1. The metal waist, metal back, strong hand exoskeleton (PHES4, PHES7, PHES9) should not be disassembled at will. Accuracy makes the auxiliary performance worse.

2. Metal waist, metal back, strong hand exoskeleton (PHES4, PHES7, PHES9) should be lightly loaded and unloaded during transportation, to avoid rain, moisture, exposure, and avoid flammable, corrosive items or chemicals such as oil, acid, alkali. Mixed medicines.

3. The metal waist, metal back, strong hand exoskeleton (PHES4, PHES7, PHES9) should be stored in a dry, ventilated warehouse, and should not be exposed to high temperatures, open flames, strong acids, and sharp hard objects. Avoid direct sunlight.

4. The wearables are soaked with sweat after use, and need to be dried before they can be stored, and can not be stacked freely, they need to be hung and placed.

5. After each use, you need to adjust it and hang it on a suitable shelf to avoid folding and stress, as shown in Figure .



6. Before each use, please check whether the wearing parts are worn, scratched or damaged, and whether the mode switching switch can be switched smoothly to ensure that they can be used normally; when bad phenomena are found, they should be replaced or repaired in time.

7. When bending over less than 500 times per day, maintain it once a week, check all wear parts for wear, scratches or damage, whether the mode switch can be switched smoothly, whether the connection parts are loose, and whether the metal parts are loose. There is deformation damage;

8. The bending times are greater than 500 times during daily use, and the maintenance is performed once every 3 days. Check all wear parts for wear, scratches or damage, whether the mode switch can be switched smoothly, whether the connecting parts are loose, and whether the metal parts are loose. There is deformation damage.

9. Metal waist, metal back, strong hand exoskeleton (PHES4, PHES7, PHES9), please use a damp cloth, clean water / warm water and mild cleaning products (cleaning products without solvent).

1) Make sure that no water enters the metal parts. Never immerse this product in water.

2) Do not use any solvents, bleach, polish, etc. to clean the product.

Contact

Thank you for choosing our products. Please fill up the "Warranty Card" and send it to us. Contact us on **400-018-2086** if you have any questions. We are happy to process your request.

Note

The information in this document is subject to change without notice. Please contact Customer Service for more information.

6th Building, 799 Xicha Rd., Baiyun District, Guangzhou, Guangdong Province, P.R.China. 510407
www.hyetone.com

产品组装

金属腰使用前安装方法：从包装箱中取出产品后，将支撑片4垂直插入胸部挡板2下方相应的孔中直到底部（下图A），保证弹珠卡在支撑片4的缺口中（图B）：

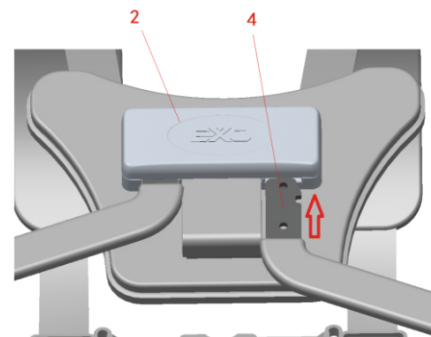

图A

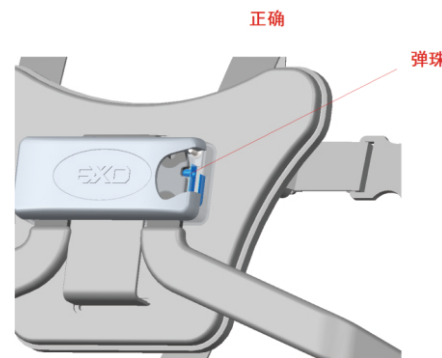

图B

结构示意图

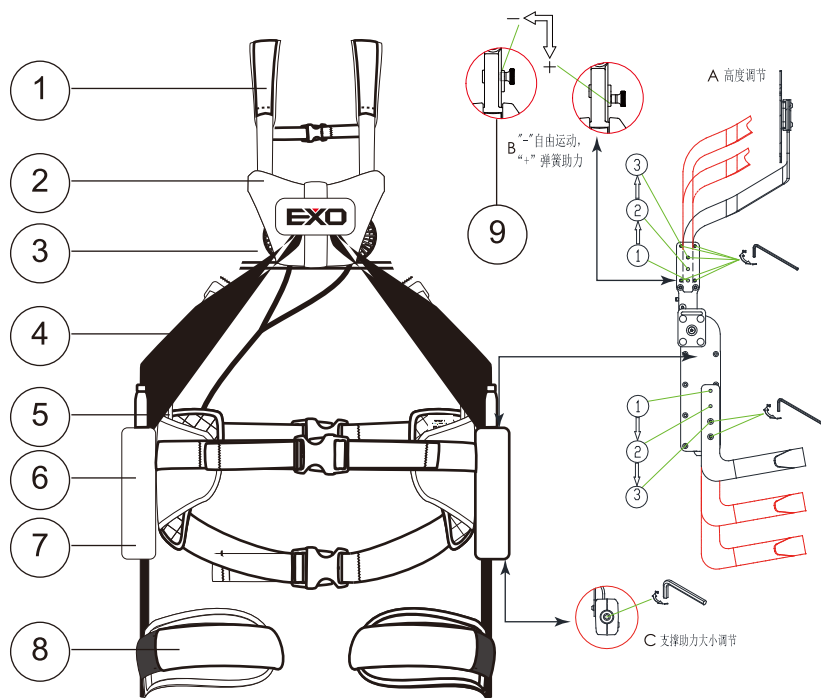

- | | |
|-----------|----------|
| 1 背带 | 6 蓄能盒 |
| 2 胸部挡板 | 7 力调节口 |
| 3 风扇 (选配) | 8 腿部挡板 |
| 4 支撑片 | 9 模式切换开关 |
| 5 腰带 | |

Warnings

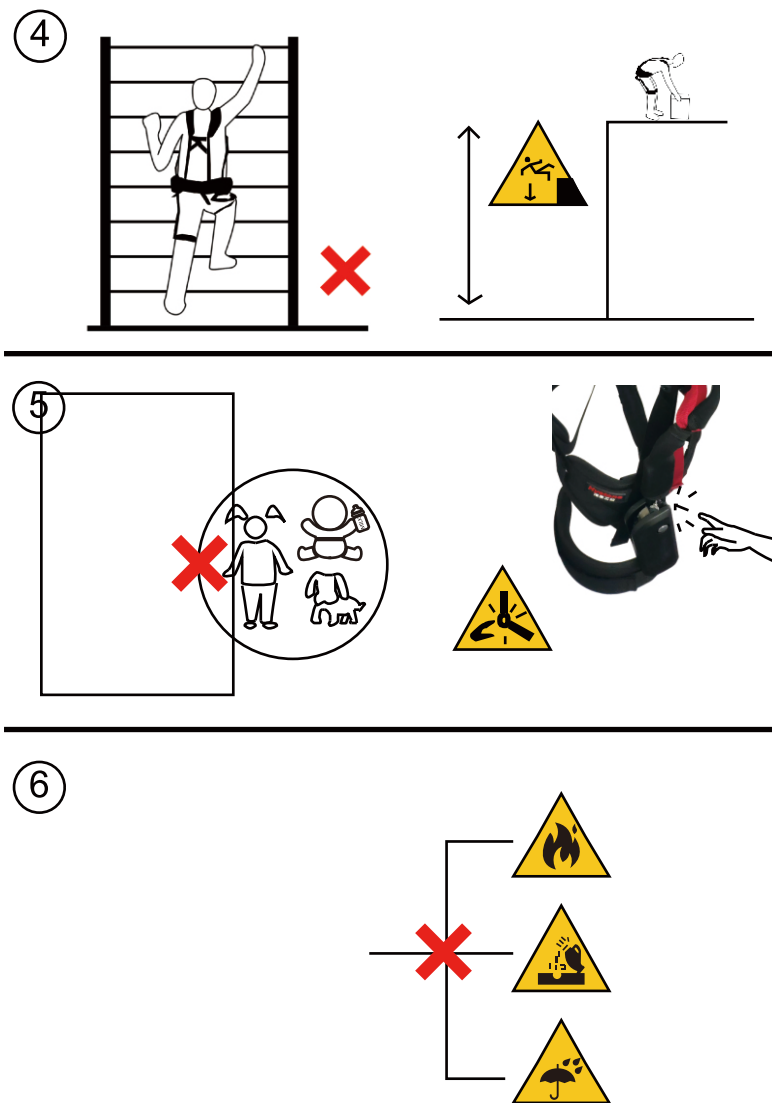

Use Tips

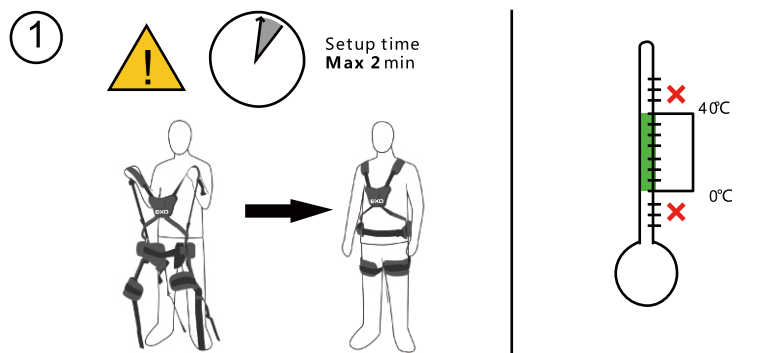

② First use

Day 1
max 1 hr

Day 2
max 2 hrs

Day 3
max 4 hrs

Day 4
max 8 hrs



③



穿戴定位

将身体腕部的旋转中心与本产品的旋转中心对齐

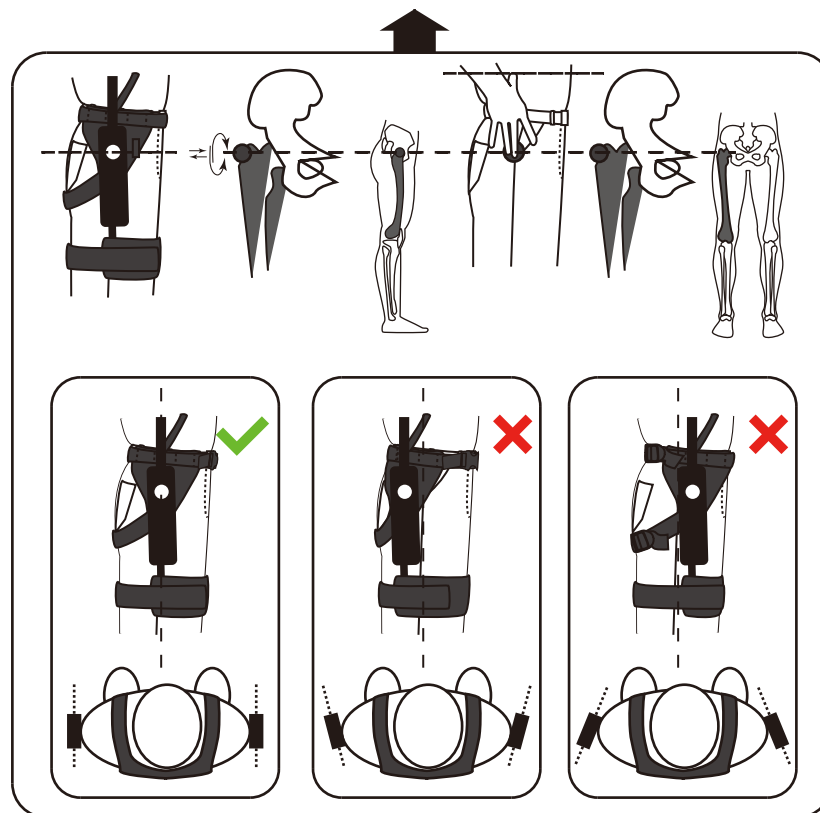
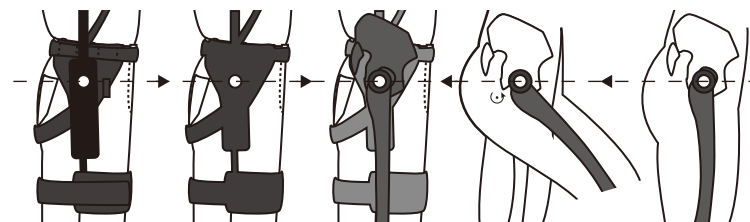

穿戴设置

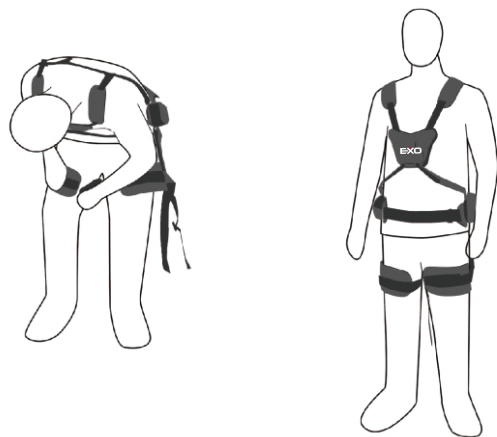
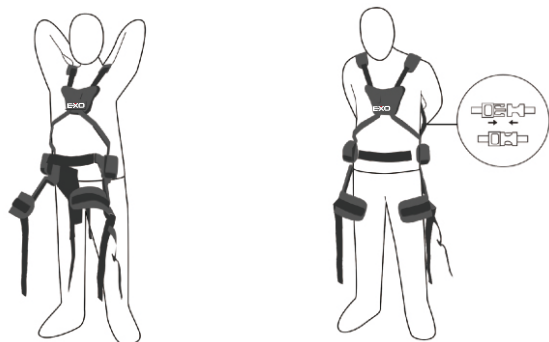
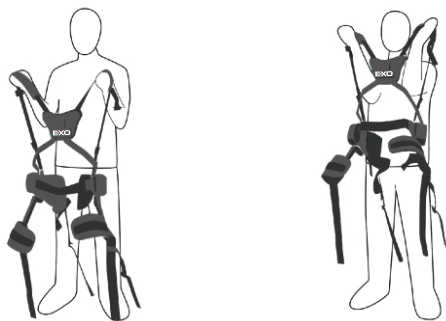

Setup/Preparations

1. Check the product for damage before donning it.
2. Pull the mechanical switches (See Fig. B on P03) to allow the pendulum swing on the hip by releasing the Energy Storage Box.
3. Fasten the buckle on your back.
4. Take bottom of the exoskeleton and put it around your head. Don it by putting it on your shoulders.
5. Align the waist with the hip joint, and adjust it to fit your waist by gently pulling the buckles. And push the buckles to fasten the belt.
6. Tighten your thighs around and press the hook-and-loop fasteners on the leg pads.
7. Align Energy Storage Boxes with the thighs and adjust the belts on the back and hip to a proper length (Lift up the end of a strap to release the belt. Pull the ends of belt to the opposite direction of the buckle to tighten it), and then adjust the front waist belt to well fit your body.
8. Push the mechanical switches (See Fig. B on P03) and bend down to make sure that the assist force is applied on your back.

Tutorial Video



Setup/Preparations

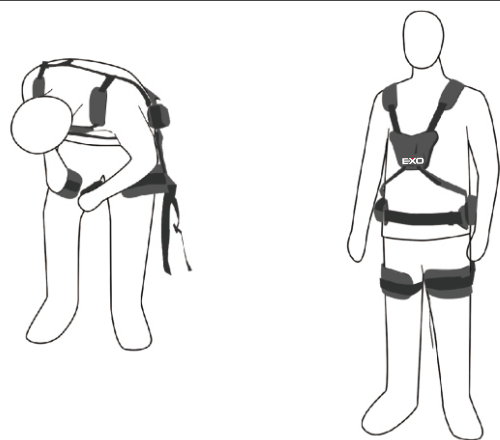
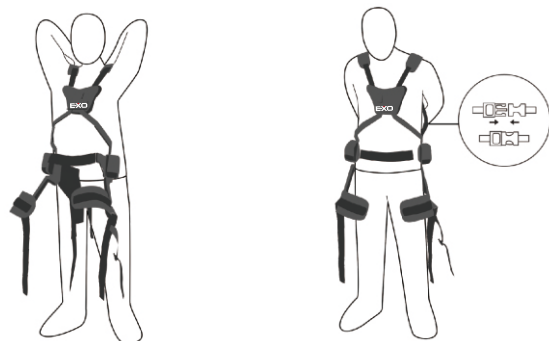
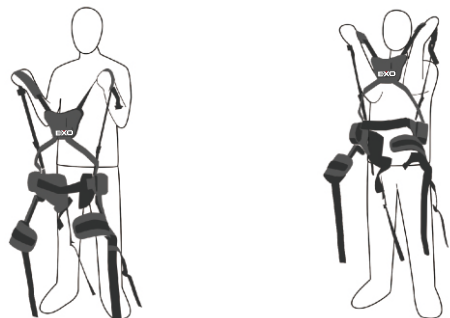

穿戴设置

- 1、使用前，注意检查产品是否有破损
- 2、上拉两边的模式切换开关（P03页细节视图B），保证蓄能盒可以自由摆动
- 3、扣紧背部卡扣
- 4、直接从头部套进外骨骼，两肩垫放在肩膀处
- 5、腰带对齐髋关节处，轻勾起背带压扣，调至适合自己的腰长，压紧扣子固定
- 6、腿部档块织带绕大腿一圈贴紧固定
- 7、两侧盒子对齐髋关节两侧，先调整后腰及臀部织带长度至舒适位置处（轻勾起调节扣尾端放松织带，拉住织带尾端向扣子返方向拉紧）再调整前腰带至舒适位置处
- 8、放下两边的模式切换开关（P03页细节视图B），做几次弯腰直腰动作，确认弹簧助力到位

外骨骼视频讲解
请扫描右方二维码查看



使用建议

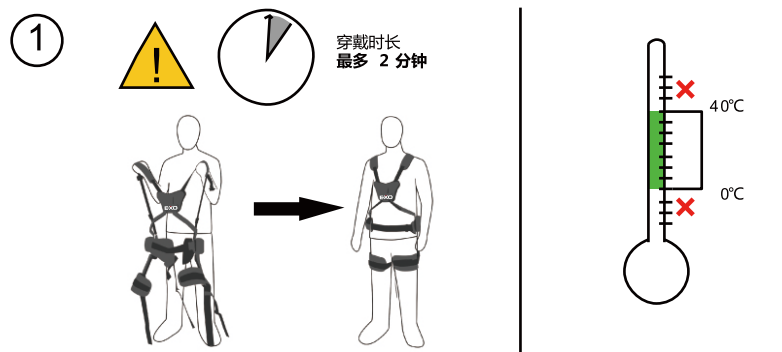

② 初次使用适应时长

第一天
最多 1小时

第二天
最多 2小时

第三天
最多 4小时

第四天
最多 8小时



③



Wear positioning

Align the center of rotation of the body hip with the center of rotation of this product

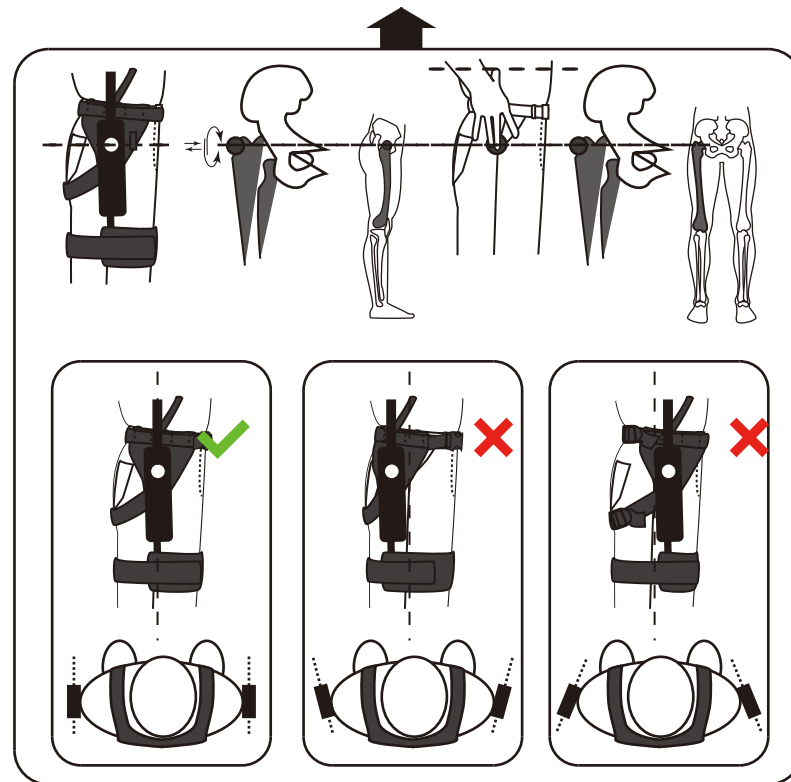
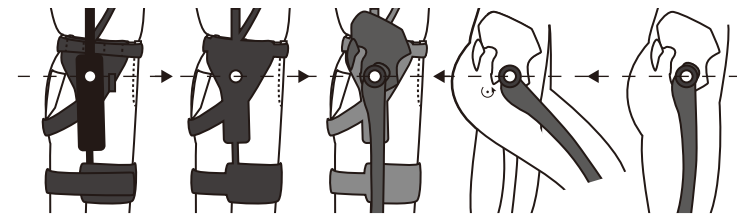

Vest Hardware

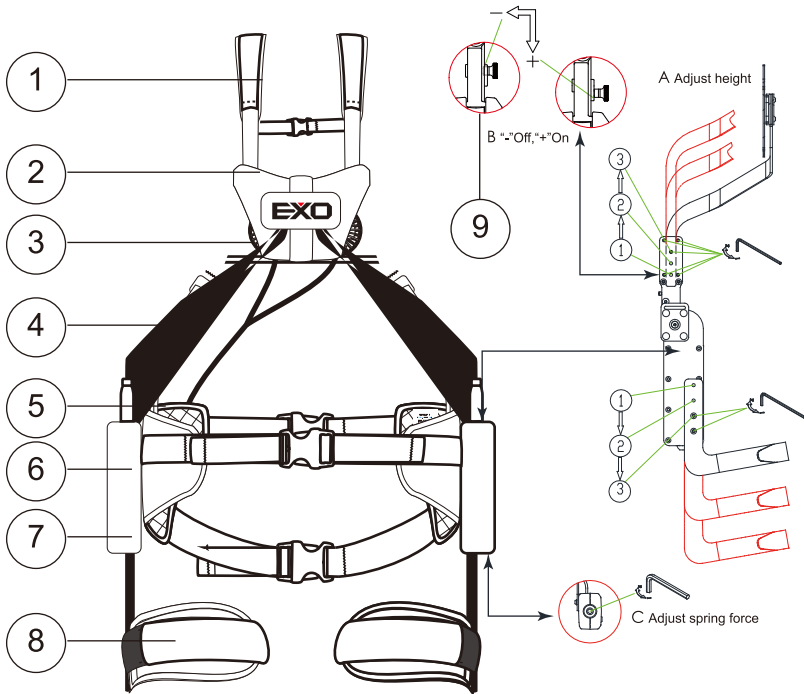

- | | |
|-----------------|--------------------------------|
| 1 Suspenders | 6 Energy Storage Box |
| 2 Chest Pad | 7 Spring Force Adjustment hole |
| 3 Fan(optional) | 8 Leg Pad |
| 4 Front Torso | 9 Mechanical switch |
| 5 Waist Belt | |

危險警示

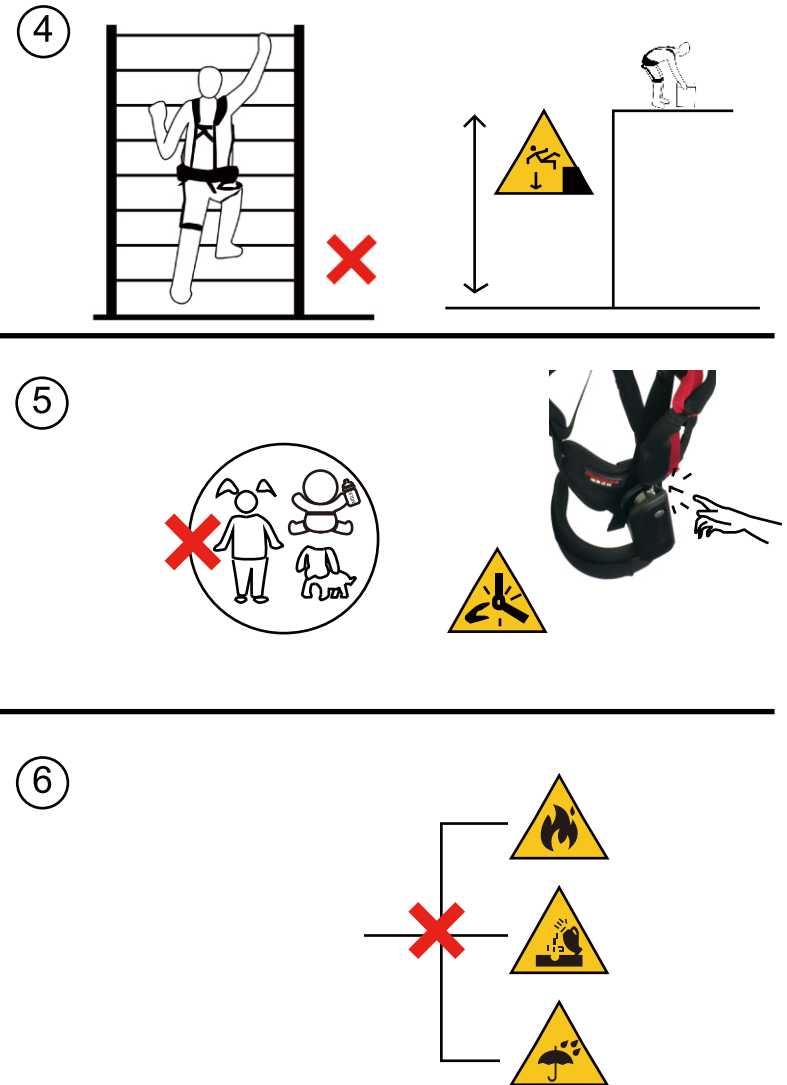

联系我们

感谢您对海同工业产品的信任与支持！为更及时的为您提供维修、咨询等服务，请认真填写《海同工业产品保修卡》，并妥善保管。

您在使用过程中如有疑问，欢迎拨打全国服务热线400-018-2086与我们联系，我们将尽快给予您满意的答复。

地址：广州市白云区西槎路聚龙工业区799号6栋一楼

邮编：510407

公司网站：www.hyetone.com

注：此说明书内容会不定期进行修订，可能会与实际产品有出入，请电话咨询海同工业客服。

Product assembly

Installation method of metal waist before use:
After removing the product from the packaging box, insert the support piece 4 vertically into the corresponding hole under the chest baffle 2 until the bottom (Figure A), to ensure that the marbles are stuck in the gap of the support piece 4 (Figure B):

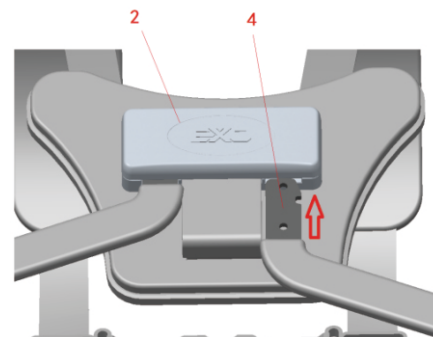

Figure A

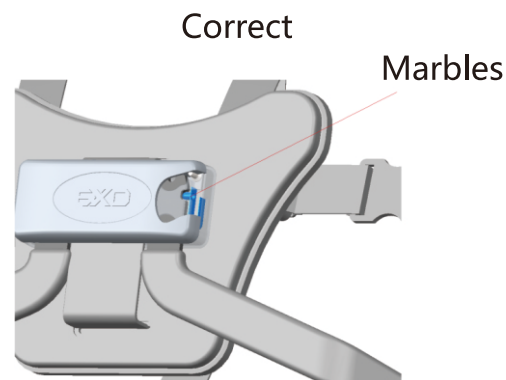

Figure B

Specifications

Model	PWIND0401
Weight	≤3.5kg
Worker Height Range	1.6~1.85m
Worker Weight Range	40~85kg
Adjustable Lift Assistance	≥60%

PW-IND-04-01-M-BK

Product Series Norm Code Size Color

Note

The information in this document is subject to change without notice. Please contact Customer Service for more information.

维护保养

1、金属腰、金属背、壮手外骨骼(PHES4、PHES7、PHES9)各部件不要随意拆卸，检查和维修工作必须由经过培训的技术人员来执行，以免影响结构的完整性和各部件的配合精度，使辅助性能变差。

2、金属腰、金属背、壮手外骨骼(PHES4、PHES7、PHES9)在运输中应轻装轻卸，避免雨淋、受潮、曝晒，避免与油、酸、碱等易燃、腐蚀物品或化学药品混装。

3、金属腰、金属背、壮手外骨骼(PHES4、PHES7、PHES9)应贮存在干燥、通风的仓库中，不得接触高温、明火、强酸和尖锐的坚硬物体，应避免阳光直射。

4、使用穿戴件被汗液湿透，需要晾干后才能存放好，且不能堆叠随意摆放，需要挂好摆放。

5、每次使用完需调节后挂在合适的架子上放好，避免折叠和受力。如右图所示。

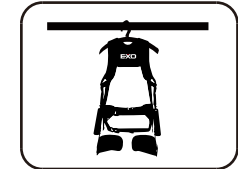

6、在每次使用前，请检查各穿戴件是否有磨损、刮伤或损坏，模式切换开关能否顺利切换，确保都能正常使用；当发现有不良现象时应及时更换或维修。

7、每天使用时弯腰次数小于500次，每1周维护1次，全面检查各穿戴件是否有磨损、刮伤或损坏，模式切换开关能否顺利切换，连接件是否有松动、金属件是否有变形损伤。

8、每天使用时弯腰次数大于500次，每3天维护1次，全面检查各穿戴件是否有磨损、刮伤或损坏，模式切换开关能否顺利切换，连接件是否有松动、金属件是否有变形损伤。

9、金属腰、金属背、壮手外骨骼(PHES4、PHES7、PHES9)，请使用湿布，清水/温水和温和的清洁产品（不含有溶剂的清洁产品）。

1) 确保没有水进入金属部件。切勿将本产品浸入水中。

2) 请勿使用任何溶剂、漂白剂、抛光剂等来清洁产品。

保修售后

WARRANTY CARD

保 修 卡

顾客姓名 _____ 购买日期 _____
产品型号 _____ 产品编号 _____

保修日期	故障及处理方法	完成日期	顾客签字

下列情况之一不在免修范围内

- 没有按说明书上的要求而造成的操作故障
- 由于自行拆卸、修理而造成的故障
- 由于意外、误用、乱用、故意损坏而造成的故障

售后服务

自购买起一年内，在正常使用情况下，购买者可凭销售发票、《保修卡》等购买凭证联系厂家提供免费服务。对于超过保修期或者不属于免费维修的产品，本公司技术服务部也会热情提供有偿服务。

注意

制造单位有改型的权利，恕不另行通知。本说明书上所有内容均经过认真核对，如有任何印刷错漏或内容上的误解，本公司保留最终解释权。

Packing List

